

We acknowledge and respect Traditional Owners as the original Custodians of the land upon which we work. We honour their Elders past and present whose knowledge and wisdom has, and will, ensure the continuation of cultures and traditional practices.

**THE DELIVERY OF
IMPERFECTION AT
SCALE – WHY
SCALE IS BETTER
THAN PERFECTION**



Image: macsautoparts.com

**“PERFECTION IS THE
ENEMY OF PROGRESS” –
WINSTON CHURCHILL**

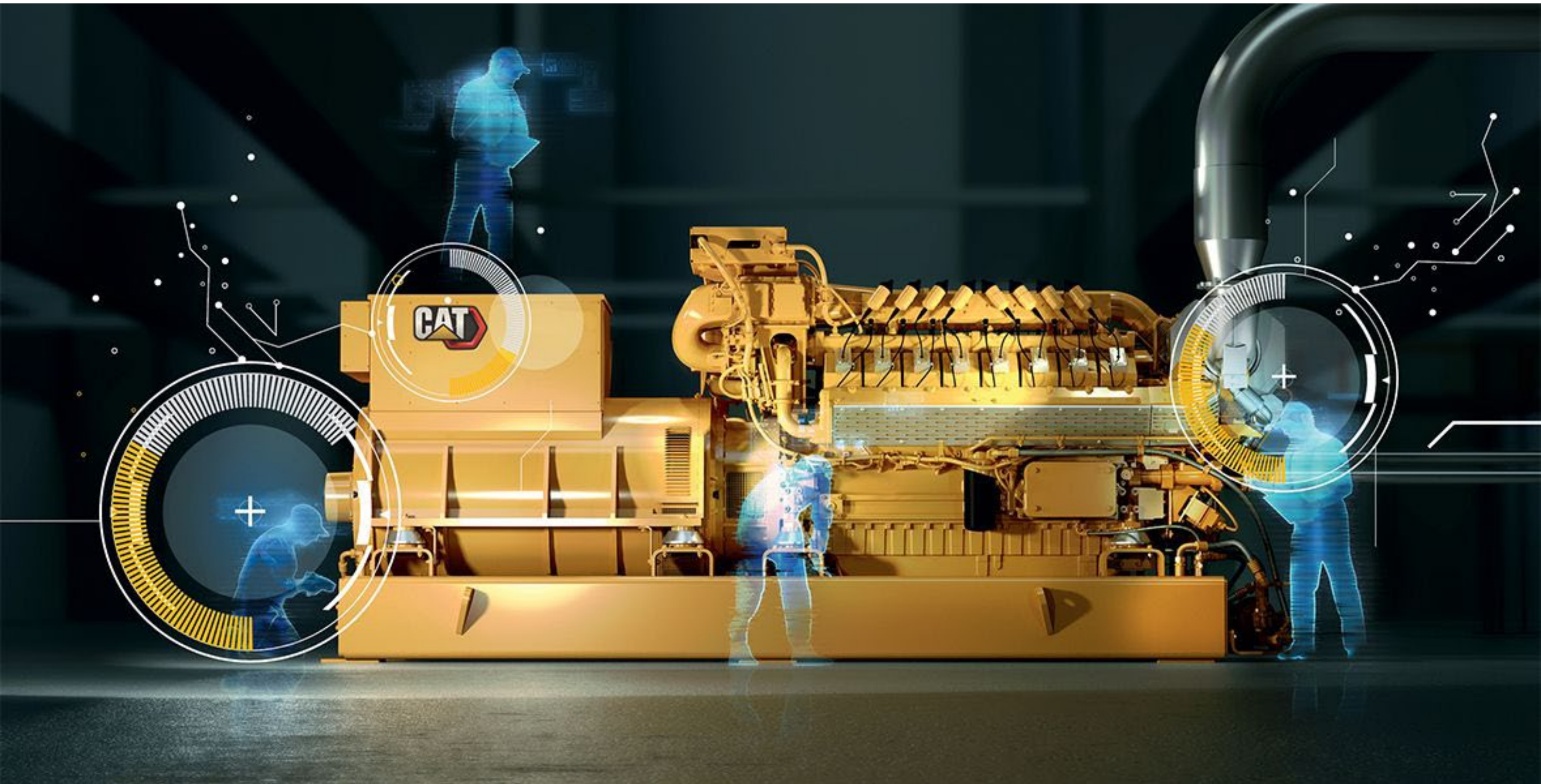
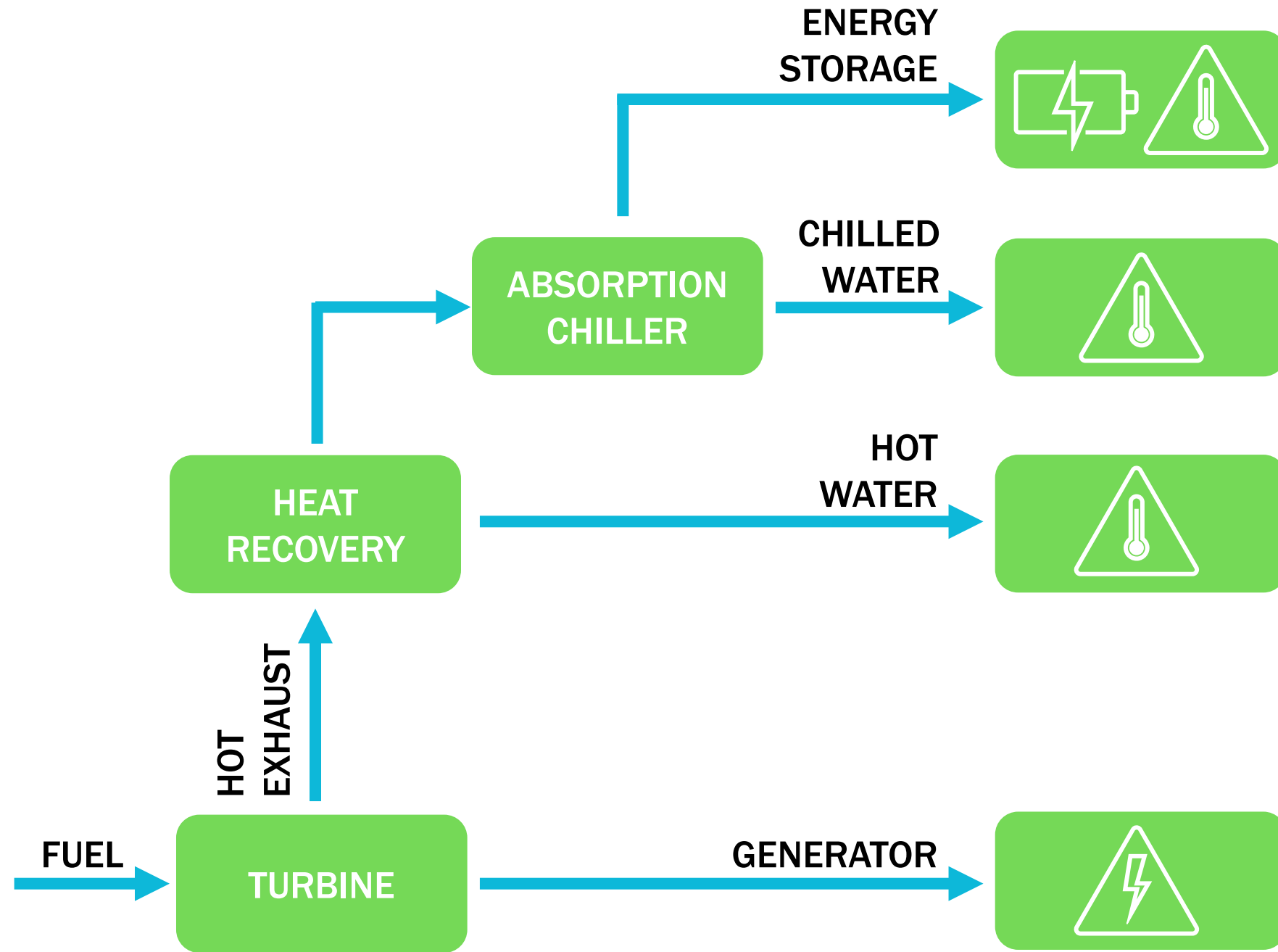

Image: Cat.com

WHAT WE LEARNNT

We continued to learn how to design for increased energy efficiency...



WHAT WE LEARNT

We continued to learn how to design for increased energy efficiency...

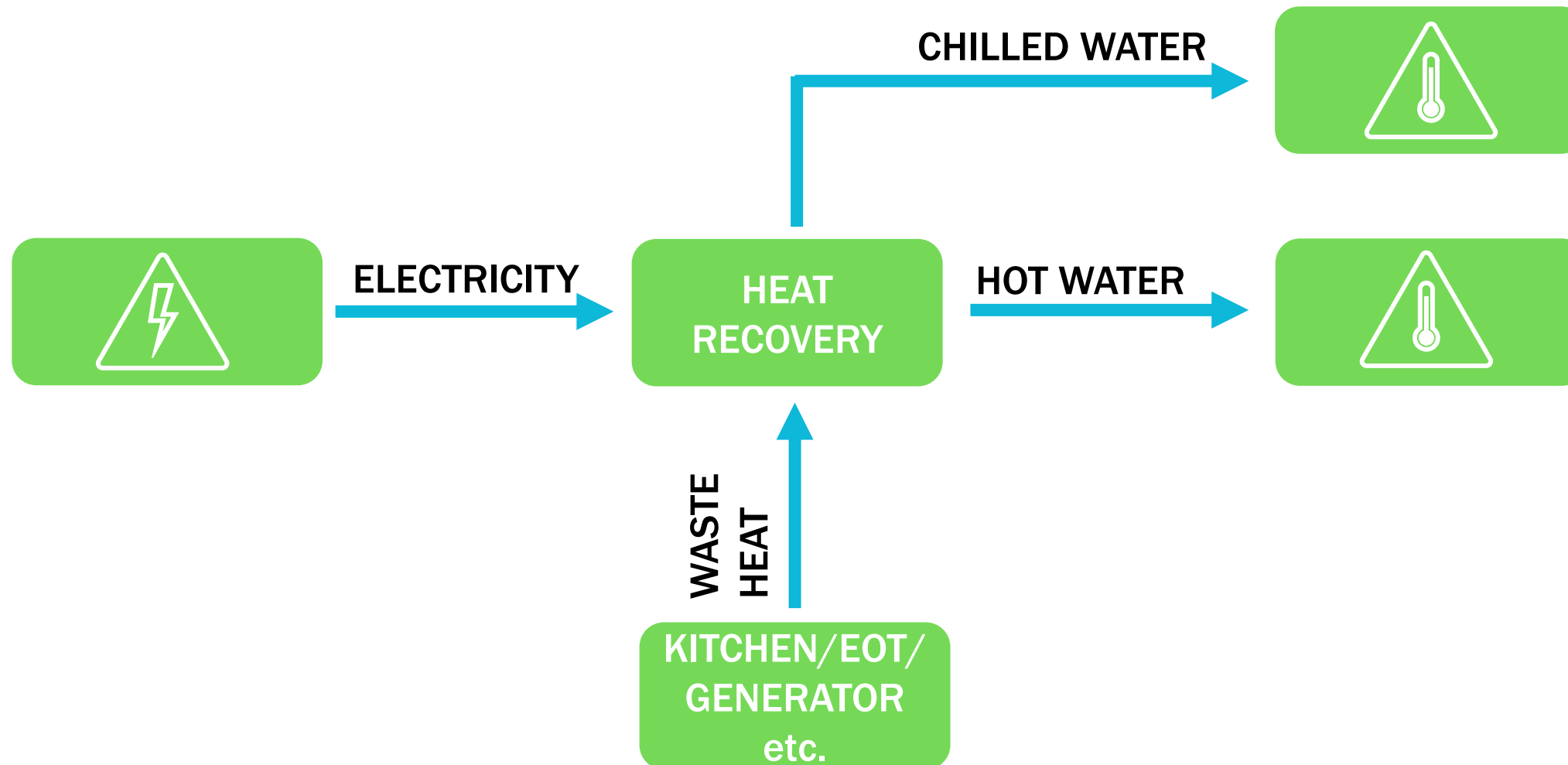

WHAT WE LEARNT

Hand in hand with NABERS, we started to shift our focus from energy to emissions...

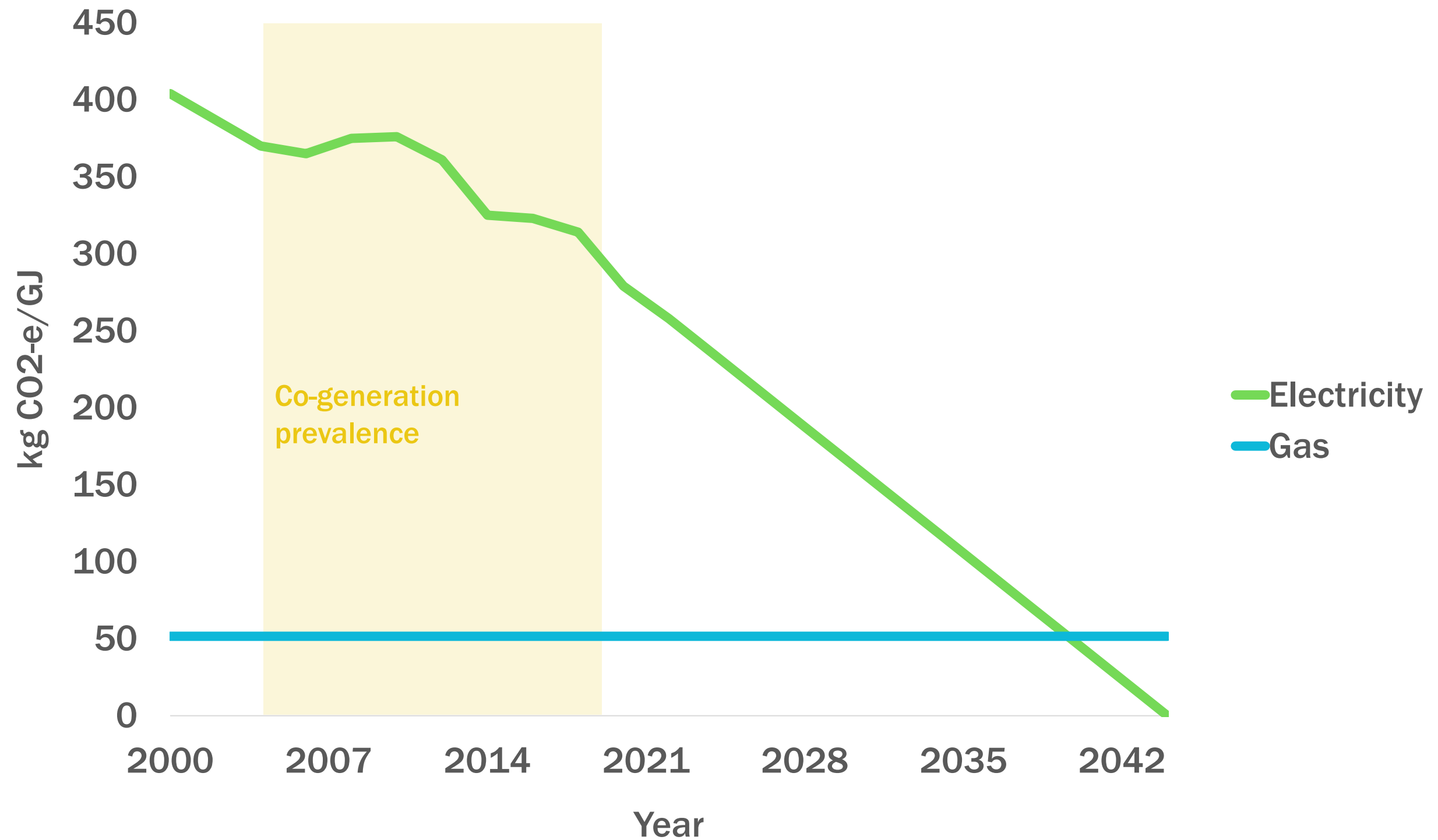

WHAT WE LEARNT

Hand in hand with NABERS, we started to shift our focus from energy to emissions...

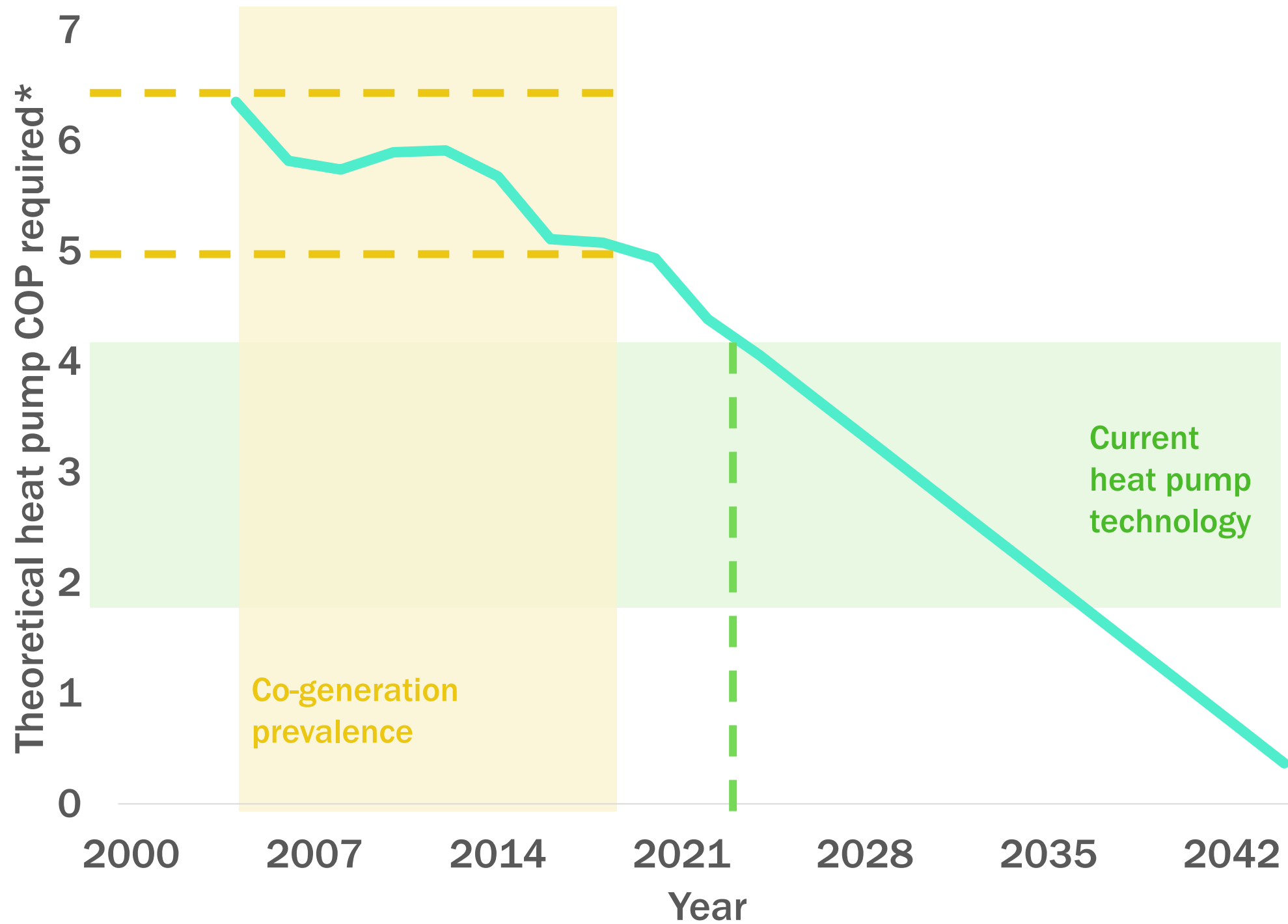

WHAT WE LEARNT

Technology and prices shift quickly – we learnt to work flexibly



Coal fired electricity	\$78-91/MWh
Combined cycle gas turbines	\$97/MWh
Wind	\$150-214/MWh
Solar	\$400-473/MWh

10 YEARS



GenCost 2021-22

Final report

Paul Graham, Jenny Hayward, James Foster and Lisa Havas
July 2022

+13-34%



-73-86%



Coal fired electricity	\$87-118/MWh
Combined cycle gas turbines	\$65-111/MWh
Wind	\$57/MWh
Solar	\$65/MWh



Image: macsautoparts.com

WHAT CAN WE DO NOW?

Don't wait to optimise

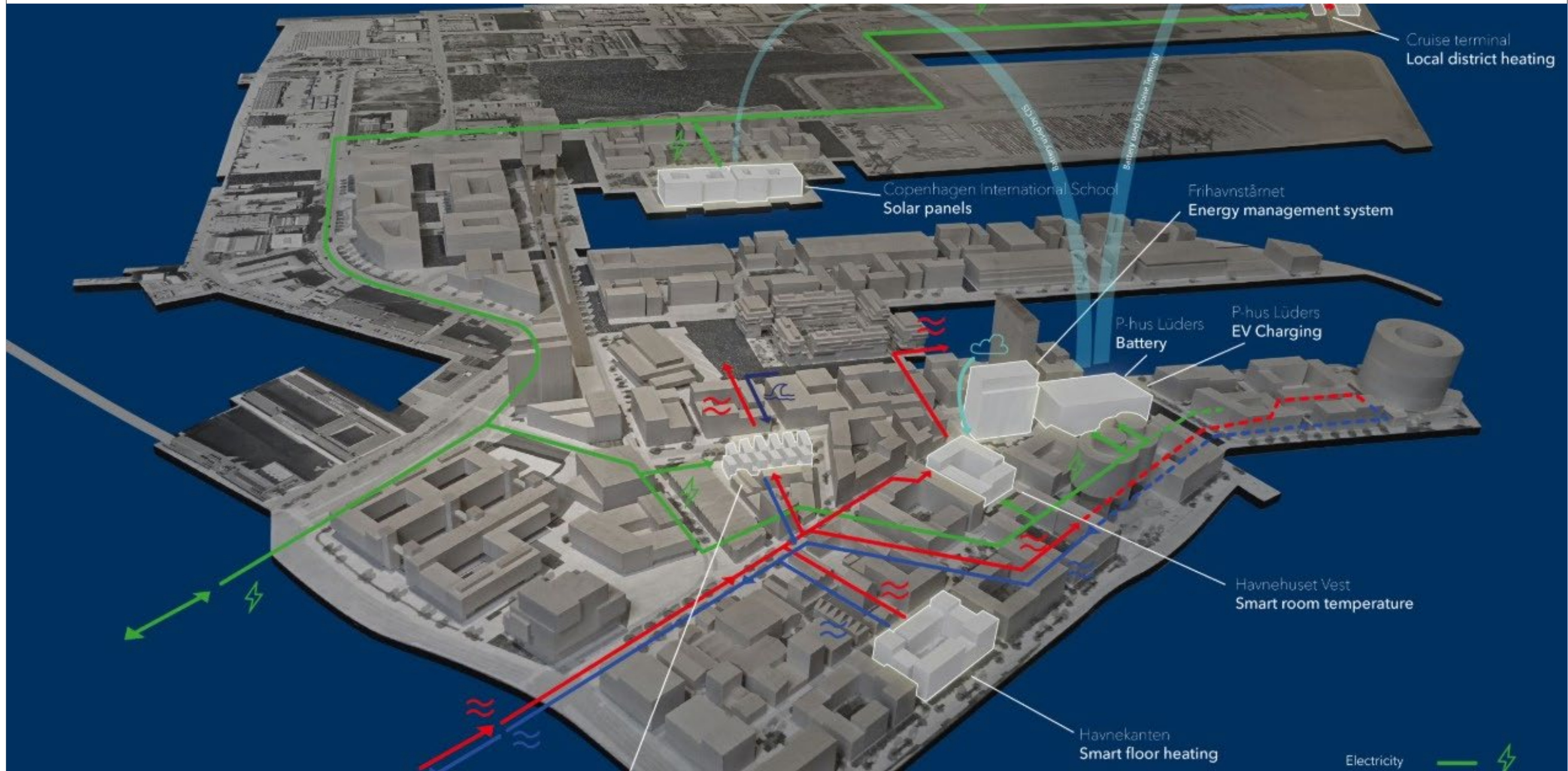

Image: energylabnordhavn.com

WHAT CAN WE DO NOW?

Use the best evidence base

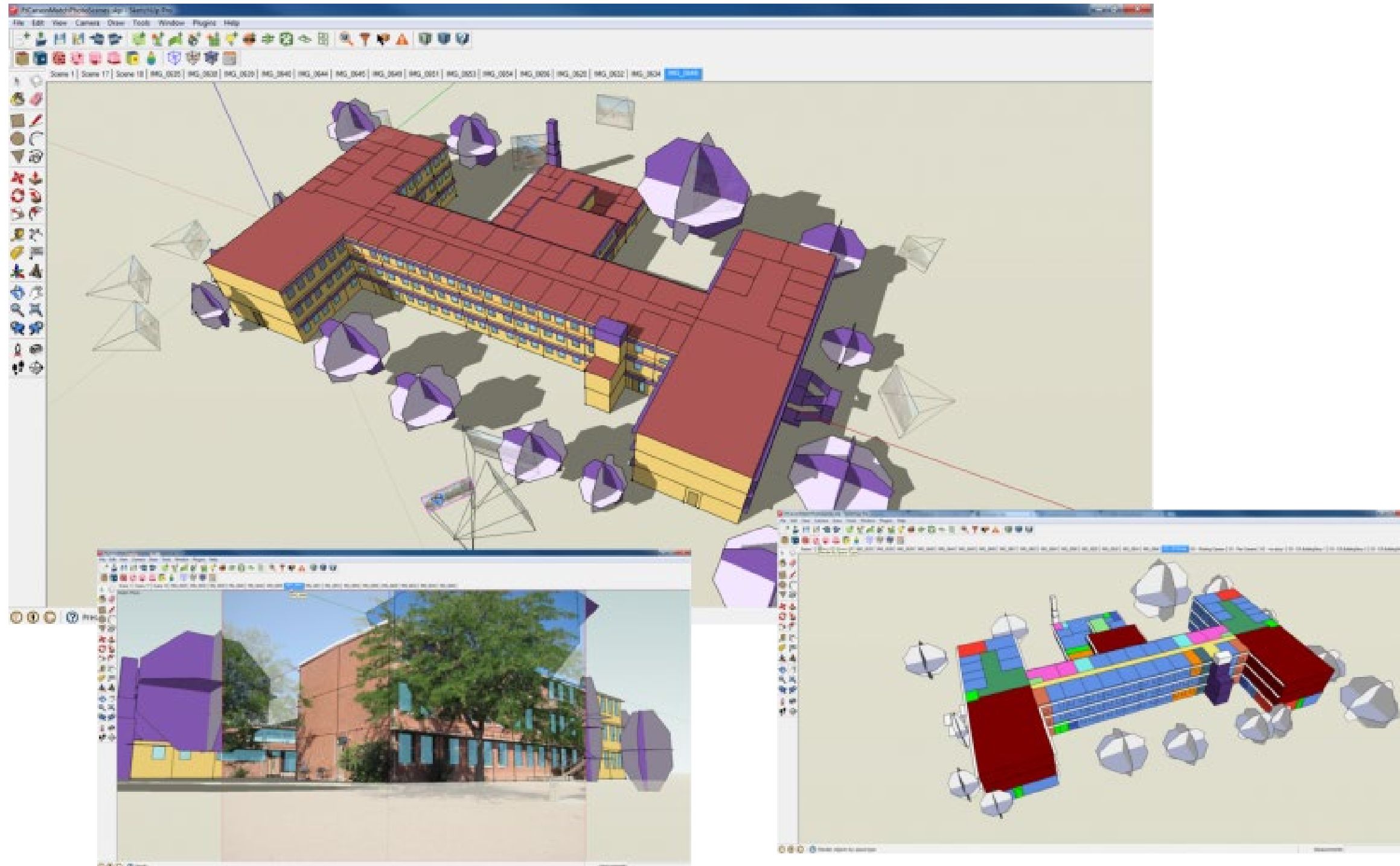

Image: energy.gov

Insert title here

WHAT CAN WE DO NOW?

Expect better things

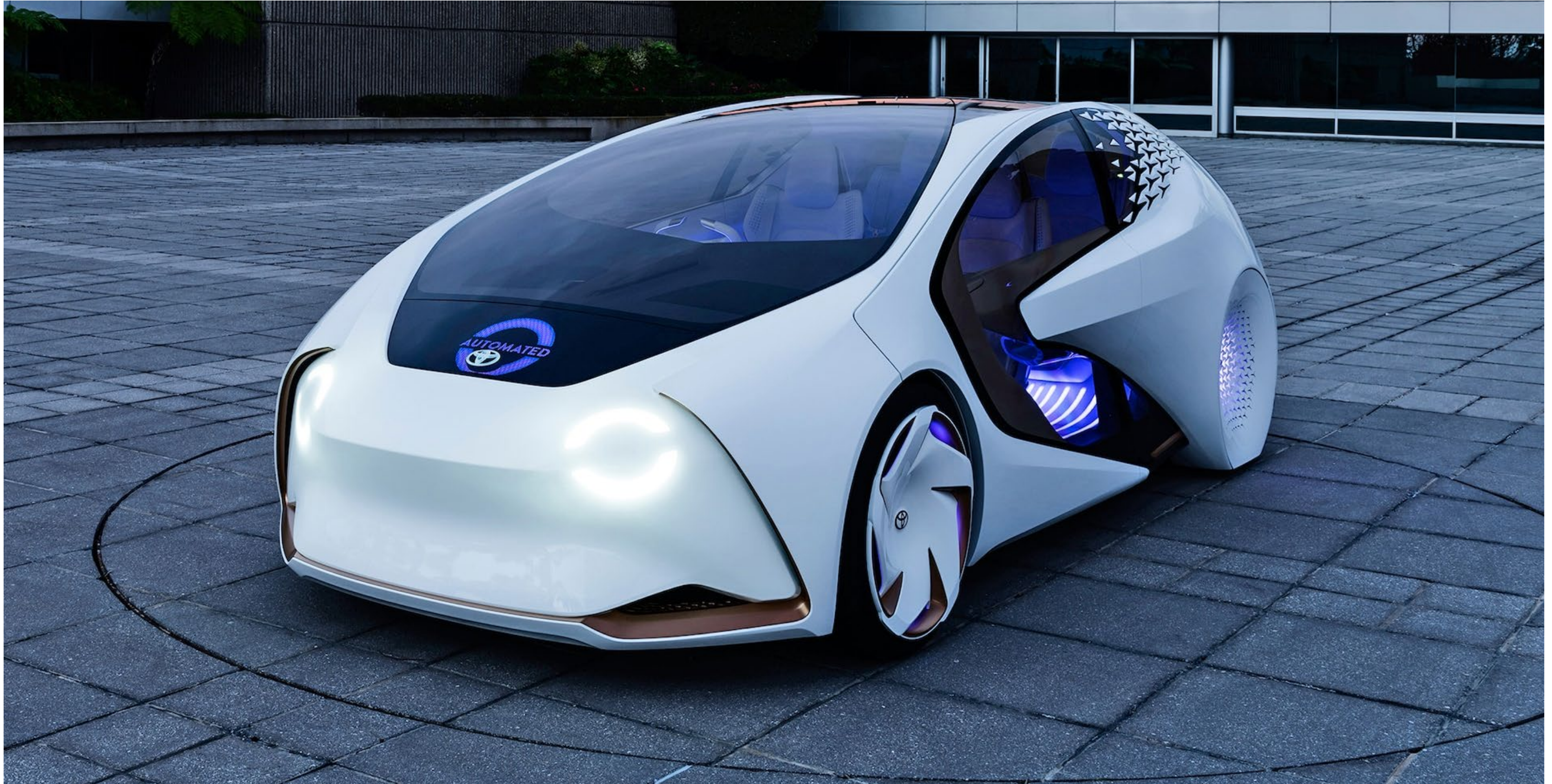

Image: motortrend.com

hassellstudio.com